

**Cheyenne/Kit Carson/Kiowa/Yuma County
Family Hunting/Outdoor Skills Challenge
(An NRA YHEC Regional Event)**

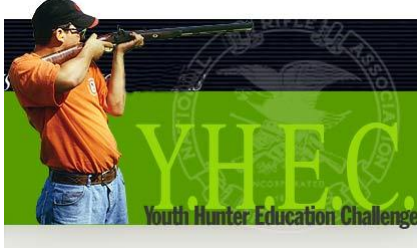

**May 5 & 6, 2007
Flagler, Colorado
Flagler Lake State Wildlife Area**

Shooter Information Packet



The Family Outdoor Challenge is coming!

- Saturday & Sunday May 5 & 6, 2007 – Registration 7:00 – 7:30 a.m. Orientation 7:45 a.m. Start 8:00 a.m. - Open to all youth and their families.
- At the Flagler Lake State Wildlife Area – Flagler, Colorado

What is a Regional YHEC Event?

First, YHEC is short for Youth Hunter Education Challenge and is a program developed by the NRA exclusively for youth and their families who enjoy hunting and the outdoors. **YHEC is NOT a Colorado Hunter Safety Certification Course!** This YHEC challenge is being co-sponsored by the Cheyenne, Kit Carson, Kiowa & Yuma County 4-H Shooting Sports Programs.

YHEC provides youth and adults with a unique opportunity to test their abilities at a variety of hunting techniques. Through completing a series of events conducted under simulated hunting conditions, participants walk away with an appreciation of all methods of hunting and gain knowledge of all types of game. This training ensures the future of the American hunting tradition as a safe, viable, recreational activity the entire family can enjoy.



Though youth participants are scored and ranked in all YHEC events, the program's competitive edge is diminished as the real "challenge" focuses on personal improvement. If youth have completed a hunter safety program, their scores will count toward the State YHEC Challenge to be held this summer. All are invited to participate in the annual NRA International YHEC event, conducted in cooperation with the International Hunter

Education Association, the event rotates in location throughout the United States to ensure the greatest number of participants.

The Challenges consists of:

- Muzzleloading Challenge – Shooting muzzleloaders at targets from a variety of unknown distances.
- Light Rifle Challenge – Shooting .22 rifles at targets from a variety of unknown distances.
- Shotgun Challenge – Shooting at clay targets in a variety of ways ... singles, doubles and even running rabbits!
- Archery Challenge – Shooting at 3-D wildlife targets from a variety of hunter challenging positions!
- Hunter's Safety Trail Challenge – Do I shoot or not? These are some of the real life hunting scenarios that will challenge you!
- Orienteering Challenge – Can you find your way using a compass? Can you read a topographic map? If you hunt ... you should know how!



- Wildlife ID Challenge – What animal left that track? What did that feather come from? As a hunter, you need to be aware of game signs ... this will challenge your knowledge.
- Hunter Responsibility Exam – As hunters ... we are all obligated to take care of our environment. Test your knowledge of hunting and our responsibilities.

How many can participate?

Due to the fact that the various Challenge activities require time to complete, we are limiting participation to 50 contestants (individual youth or in family groups) per day.

How much does this cost?

The cost to youth and families is \$25.00 per shooter. This includes .22 ammunition, muzzleloader powder and ball (.50 cal.), shotgun ammunition and all targets.



What is the deadline to sign up and pay?

You will need to fill out the attached form and send it along with your check for the shooting fees to arrive at the Area Extension Office by no later than April 27, 2007. This is first come first served. You will need to make your checks payable to the ***Kit Carson County Extension Activity Fund***. Send your registration form and check to:

Area Extension Office
c/o Perry Brewer
251 16th St. Suite 101
Burlington, CO 80807

If you have questions or need more information on the YHEC Challenge you may call Perry Brewer at (719) 346-5571, Tim Burton at (719) 767-5716, Bruce Fickenscher at (719) 438-5321 or Eldon Fisher at (970) 332-4151.

What do I need to bring?

Shooters will need to bring their own sporting arms (shotguns, .22 rifles & muzzleloaders) and bows (with arrows). In addition, shooters will need to provide adequate eye and ear protection. We will be providing the following:

- .22 cal. long rifle ammunition
- 12 ga. light field loads and all clay targets
- .50 cal. round ball, Pyrodex black powder, caps and patches
- All targets for the various challenges



Due to differences in and variety of bows, we **will not** be supplying arrows!

What if I don't have everything?

Don't worry! We will have a limited number of sporting arms and bows for contestants to use for the various challenges! We want all contestants to try all the challenges ... so if you don't have something and you can't borrow one ... come anyway!

Miscellaneous items:

- Light concessions (snacks) will be available at the contest site but plan on bringing your own food, break items and hydration liquids.
- Restrooms are available at various locations in the contest area.
- Be prepared for a variety of weather conditions ... including rain and snow! (Remember, this is still only early May and anything can happen!)
- If there are parents, adults or older youth who would like to help running a challenge, let us know! You do not have to have experience! We will teach you what you need to know.

2007 YHEC Event Flagler Lake Map

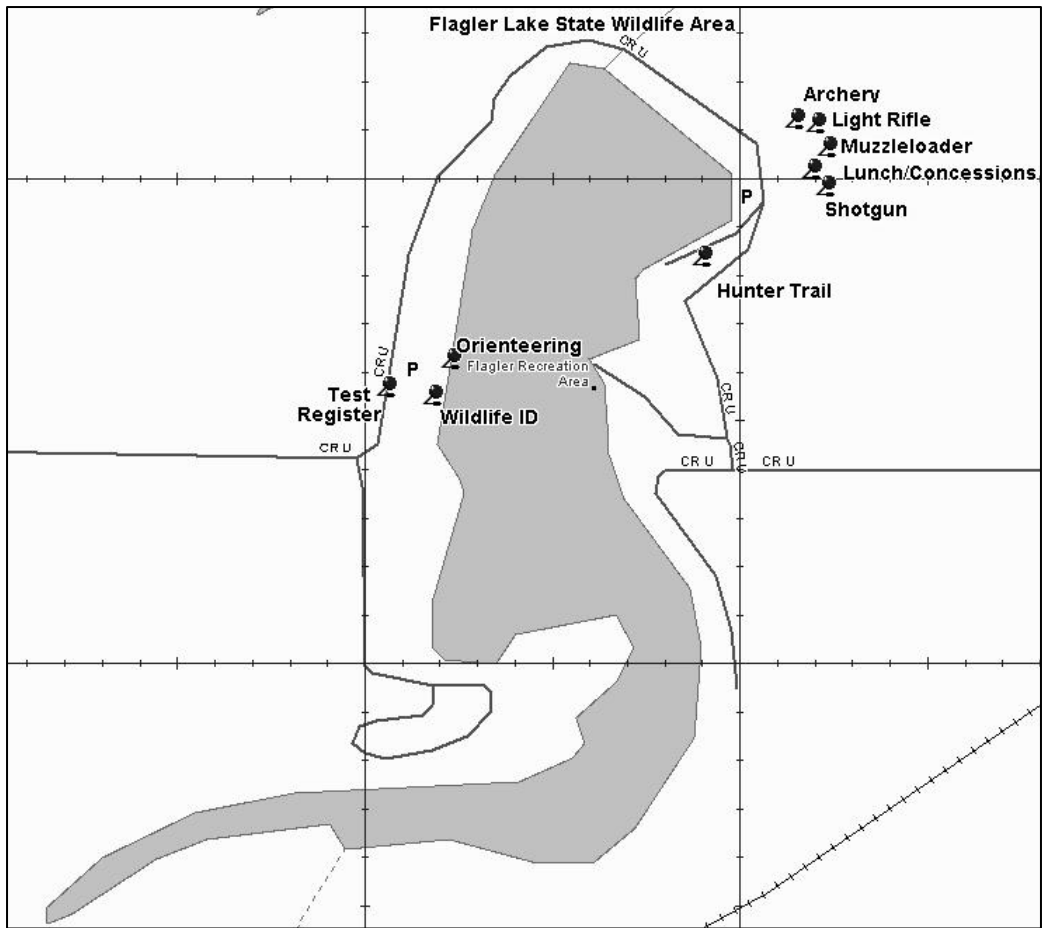
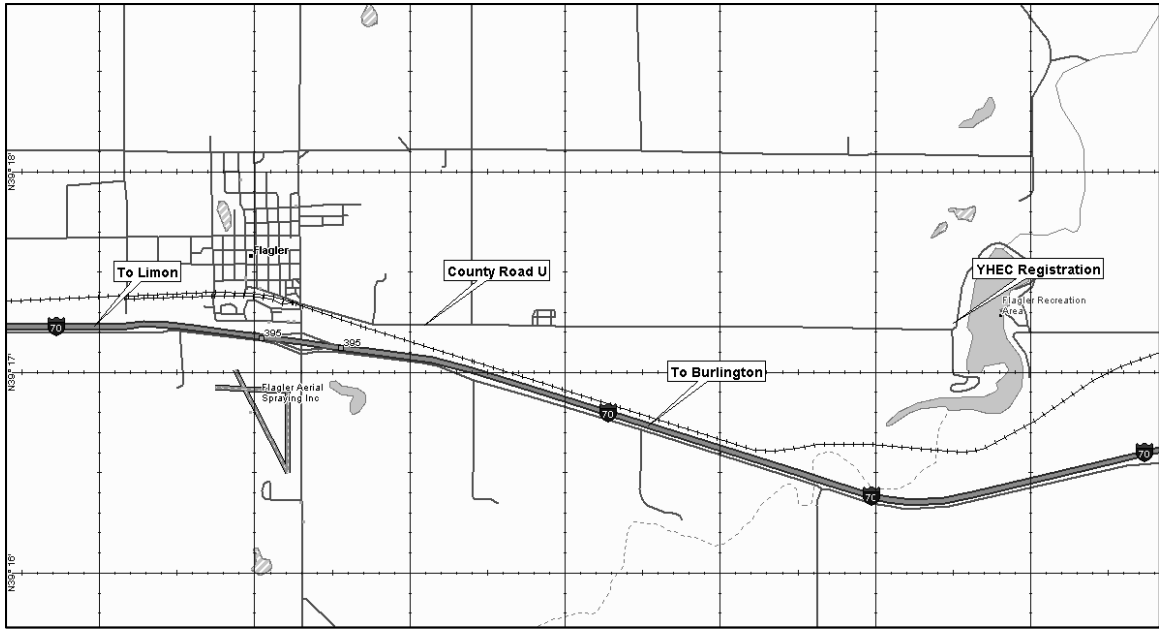

Contest Notes:

Cheyenne/Kit Carson/Yuma County 2007 YHEC Event Registration May 5 & 6, 2007

Contact Person (Adult): _____

Address: _____

City: _____ State: _____ Zip: _____

Daytime Phone Number: _____

Please Check All That Apply: (Deadline: April 27, 2007)

Non 4-H youth or family \$25.00/shooter 4-H youth or family \$25.00/shooter

Day Attending: Saturday _____ or Sunday _____

Youth Shooter Name	\$	HSC (Y/N)	Adult Shooter Name	\$
Sub total youth -----			Sub total adult -----	

HSC = Does the **Youth** Shooter have a Hunter Safety Card?

Grand Total Cost: \$ _____ ← Please Enclose This Amount with this Form

Make Checks Payable To: *Kit Carson County Extension Activity Fund*

Mail to: Area Extension Office, c/o Perry D. Brewer, 251 16th St. Suite 101, Burlington, CO 80807

For Office Use Only:

Date Received: _____ Check Number: _____

Assigned Shooter Numbers: _____